

SXM 0400000955
£190

CYC 009569
End of Repts
13/12/18
ANNEX 2



York
Application to vary a premises licence
Licensing Act 2003

For help contact
licensing.unit@york.gov.uk
Telephone: 01904 552512

* required information

Section 1 of 18

You can save the form at any time and resume it later. You do not need to be logged in when you resume.

System reference This is the unique reference for this application generated by the system.

Your reference You can put what you want here to help you track applications if you make lots of them. It is passed to the authority.

Are you an agent acting on behalf of the applicant?

Put "no" if you are applying on your own behalf or on behalf of a business you own or work for.

Yes No

Applicant Details

* First name

* Family name

* E-mail

Main telephone number Include country code.

Other telephone number

Indicate here if the applicant would prefer not to be contacted by telephone

Is the applicant:

Applying as a business or organisation, including as a sole trader

Applying as an individual

A sole trader is a business owned by one person without any special legal structure. Applying as an individual means the applicant is applying so the applicant can be employed, or for some other personal reason, such as following a hobby.

Applicant Business

Is the applicant's business registered in the UK with Companies House? Yes No

Is the applicant's business registered outside the UK? Yes No

Note: completing the Applicant Business section is optional in this form.

Business name If the applicant's business is registered, use its registered name.

VAT number Put "none" if the applicant is not registered for VAT.

Continued from previous page...

Legal status

Applicant's position in the business

Home country

The country where the applicant's headquarters are.

Applicant Business Address

Building number or name

Street

District

City or town

County or administrative area

Postcode

Country

If the applicant has one, this should be the applicant's official address - that is an address required of the applicant by law for receiving communications.

Agent Details

* First name

* Family name

* E-mail

Main telephone number

Include country code.

Other telephone number

Indicate here if you would prefer not to be contacted by telephone

Are you:

An agent that is a business or organisation, including a sole trader

A sole trader is a business owned by one person without any special legal structure.

A private individual acting as an agent

Agent Business

Is your business registered in the UK with Companies House? Yes No

Note: completing the Applicant Business section is optional in this form.

Registration number

Business name

If your business is registered, use its registered name.

VAT number

Put "none" if you are not registered for VAT.

Legal status

Continued from previous page...

Your position in the business

Home country

The country where the headquarters of your business is located.

Agent Registered Address

Address registered with Companies House.

Building number or name

Street

District

City or town

County or administrative area

Postcode

Country

Section 2 of 18

APPLICATION DETAILS

This application cannot be used to vary the licence so as to extend the period for which the licence has effect or to vary substantially the premises to which it relates. If you wish to make that type of change to the premises licence, you should make a new premises licence application under section 17 of the Licensing Act 2003.

I/we, as named in section 1, being the premises licence holder, apply to vary a premises licence under section 34 of the Licensing Act 2003 for the premises described in section 2 below.

* Premises Licence Number

Are you able to provide a postal address, OS map reference or description of the premises?

Address OS map reference Description

Postal Address Of Premises

Building number or name

Street

District

City or town

County or administrative area

Postcode

Country

Premises Contact Details

Telephone number

Continued from previous page...

Non-domestic rateable
value of premises (£)

26,750

Section 3 of 18

VARIATION

Do you want the proposed
variation to have effect as
soon as possible? Yes No

Do you want the proposed variation to have effect in relation to the
introduction of the late night levy?

Yes No

You do not have to pay a fee if the only
purpose of the variation for which you are
applying is to avoid becoming liable to the
late night levy.

If your proposed variation
would mean that 5,000 or
more people are expected to
attend the premises at any
one time, state the number
expected to attend

Describe Briefly The Nature Of The Proposed Variation

Describe the premises. For example the type of premises, its general situation and layout and any other information which could be relevant to the licensing objectives. Where your application includes off-supplies of alcohol and you intend to provide a place for consumption of these off-supplies, you must include a description of where the place will be and its proximity to the premises.

1. Change of hours to 06:00 to 23:00 Monday to Sunday for the sale of alcohol and opening hours.
2. Change of plan.
3. To remove all embedded restrictions
4. To apply more appropriate conditions

Section 4 of 18

PROVISION OF PLAYS

See guidance on regulated entertainment

Will the schedule to provide plays be subject to change if this application to
vary is successful?

Yes No

Section 5 of 18

PROVISION OF FILMS

See guidance on regulated entertainment

Will the schedule to provide films be subject to change if this application to
vary is successful?

Yes No

Section 6 of 18

PROVISION OF INDOOR SPORTING EVENTS

Continued from previous page...

See guidance on regulated entertainment

Will the schedule to provide indoor sporting events be subject to change if this application to vary is successful?

Yes No

Section 7 of 18

PROVISION OF BOXING OR WRESTLING ENTERTAINMENTS

See guidance on regulated entertainment

Will the schedule to provide boxing or wrestling entertainments be subject to change if this application to vary is successful?

Yes No

Section 8 of 18

PROVISION OF LIVE MUSIC

See guidance on regulated entertainment

Will the schedule to provide live music be subject to change if this application to vary is successful?

Yes No

Section 9 of 18

PROVISION OF RECORDED MUSIC

See guidance on regulated entertainment

Will the schedule to provide recorded music be subject to change if this application to vary is successful?

Yes No

Section 10 of 18

PROVISION OF PERFORMANCES OF DANCE

See guidance on regulated entertainment

Will the schedule to provide performances of dance be subject to change if this application to vary is successful?

Yes No

Section 11 of 18

PROVISION OF ANYTHING OF A SIMILAR DESCRIPTION TO LIVE MUSIC, RECORDED MUSIC OR PERFORMANCES OF DANCE

See guidance on regulated entertainment

Will the schedule to provide anything similar to live music, recorded music or performances of dance be subject to change if this application to vary is successful?

Yes No

Section 12 of 18

PROVISION OF LATE NIGHT REFRESHMENT

Continued from previous page...

Will the schedule to provide late night refreshment be subject to change if this application to vary is successful?

Yes No

Section 13 of 18

SUPPLY OF ALCOHOL

Will the schedule to supply alcohol be subject to change if this application to vary is successful?

Yes No

Standard Days And Timings

MONDAY

Start

End

Start

End

Provide timings in 24 hour clock (e.g., 16:00) and only give details for the days of the week when you intend the premises to be used for the activity.

TUESDAY

Start

End

Start

End

WEDNESDAY

Start

End

Start

End

THURSDAY

Start

End

Start

End

FRIDAY

Start

End

Start

End

SATURDAY

Start

End

Start

End

SUNDAY

Start

End

Start

End

Continued from previous page...

Will the sale of alcohol be for consumption?

- On the premises Off the premises Both

If the sale of alcohol is for consumption on the premises select on, if the sale of alcohol is for consumption away from the premises select off. If the sale of alcohol is for consumption on the premises and away from the premises select both.

State any seasonal variations.

For example (but not exclusively) where the activity will occur on additional days during the summer months.

None

Non-standard timings. Where the premises will be used for the supply of alcohol at different times from those listed above, list below.

For example (but not exclusively), where you wish the activity to go on longer on a particular day e.g. Christmas Eve.

None

Section 14 of 18

ADULT ENTERTAINMENT

Highlight any adult entertainment or services, activities, or other entertainment or matters ancillary to the use of the premises that may give rise to concern in respect of children.

Provide information about anything intended to occur at the premises or ancillary to the use of the premises which may give rise to concern in respect of children, regardless of whether you intend children to have access to the premises, for example (but not exclusively) nudity or semi-nudity, films for restricted age groups etc gambling machines etc.

None

Section 15 of 18

HOURS PREMISES ARE OPEN TO THE PUBLIC

Standard Days And Timings

MONDAY

Start

End

Start

End

TUESDAY

Start

End

Start

End

Provide timings in 24 hour clock (e.g., 16:00) and only give details for the days of the week when you intend the premises to be used for the activity.

Continued from previous page...

WEDNESDAY

Start End
Start End

THURSDAY

Start End
Start End

FRIDAY

Start End
Start End

SATURDAY

Start End
Start End

SUNDAY

Start End
Start End

State any seasonal variations.

For example (but not exclusively) where the activity will occur on additional days during the summer months.

None

Non standard timings. Where you intend to use the premises to be open to the members and guests at different times from those listed above, list below.

For example (but not exclusively), where you wish the activity to go on longer on a particular day e.g. Christmas Eve.

None

Identify those conditions currently imposed on the licence which you believe could be removed as a consequence of the proposed variation you are seeking.

Removal of all embedded restrictions and replace with more appropriate conditions.

I have enclosed the premises licence

Continued from previous page...

I have enclosed the relevant part of the premises licence

Reasons why I have failed to enclose the premises licence or relevant part of premises licence.

Section 16 of 18

LICENSING OBJECTIVES

Describe the steps you intend to take to promote the four licensing objectives:

a) General – all four licensing objectives (b,c,d,e)

List here steps you will take to promote all four licensing objectives together.

As below.

b) The prevention of crime and disorder

A CCTV system will be in operation at the premises and recorded images shall be retained for a period of 31 days. CCTV images will be provided to the police and other responsible authorities as soon as practicable and in any case within 48 hours of a request for such images, subject of the provisions of the DPA.

A register of refusals of alcohol will be maintained at the premises. The register shall be examined on a regular basis by the duty manager/ DPS and the date and time of each examination will be endorsed in the register. The register will be made available for inspection by the Police and other authorised officers of the council upon reasonable request.

c) Public safety

An incident register will be maintained at the premises and made available to the authorities on request.

d) The prevention of public nuisance

A notice will be on display asking that the customers leave the area quietly and respect the local residents.

e) The protection of children from harm

The premises will adopt a 'Challenge 25' policy. This means that if a customer purchasing alcohol appears to be under the age of 25 they will be asked for proof of their age, to prove that they are 18 years or older.

Posters will be on display advising customers of the 'Challenge 25' policy.

The only forms of identification that will be accepted at the premises are a passport, UK photo-card driving licences, & cards bearing the 'PASS' hologram.

Continued from previous page...

Section 17 of 18

NOTES ON REGULATED ENTERTAINMENT

In terms of specific **regulated entertainments** please note that:

- Plays: no licence is required for performances between 08:00 and 23.00 on any day, provided that the audience does not exceed 500.
- Films: no licence is required for 'not-for-profit' film exhibition held in community premises between 08.00 and 23.00 on any day provided that the audience does not exceed 500 and the organiser (a) gets consent to the screening from a person who is responsible for the premises; and (b) ensures that each such screening abides by age classification ratings.
- Indoor sporting events: no licence is required for performances between 08.00 and 23.00 on any day, provided that the audience does not exceed 1000.
- Boxing or Wrestling Entertainment: no licence is required for a contest, exhibition or display of Greco-Roman wrestling, or freestyle wrestling between 08.00 and 23.00 on any day, provided that the audience does not exceed 1000. Combined fighting sports – defined as a contest, exhibition or display which combines boxing or wrestling with one or more martial arts – are licensable as a boxing or wrestling entertainment rather than an indoor sporting event.
- Live music: no licence permission is required for:
 - a performance of unamplified live music between 08.00 and 23.00 on any day, on any premises.
 - a performance of amplified live music between 08.00 and 23.00 on any day on premises authorised to sell alcohol for consumption on those premises, provided that the audience does not exceed 500.
 - a performance of amplified live music between 08.00 and 23.00 on any day, in a workplace that is not licensed to sell alcohol on those premises, provided that the audience does not exceed 500.
 - a performance of amplified live music between 08.00 and 23.00 on any day, in a church hall, village hall, community hall, or other similar community premises, that is not licensed by a premises licence to sell alcohol, provided that (a) the audience does not exceed 500, and (b) the organiser gets consent for the performance from a person who is responsible for the premises.
 - a performance of amplified live music between 08.00 and 23.00 on any day, at the non-residential premises of (i) a local authority, or (ii) a school, or (iii) a hospital, provided that (a) the audience does not exceed 500, and (b) the organiser gets consent for the performance on the relevant premises from: (i) the local authority concerned, or (ii) the school or (iii) the health care provider for the hospital.
- Recorded Music: no licence permission is required for:
 - any playing of recorded music between 08.00 and 23.00 on any day on premises authorised to sell alcohol for consumption on those premises, provided that the audience does not exceed 500.
 - any playing of recorded music between 08.00 and 23.00 on any day, in a church hall, village hall, community hall, or other similar community premises, that is not licensed by a premises licence to sell alcohol, provided that (a) the audience does not exceed 500, and (b) the organiser gets consent for the performance from a person who is responsible for the premises.
 - any playing of recorded music between 08.00 and 23.00 on any day, at the non-residential premises of (i) a local authority, or (ii) a school, or (iii) a hospital, provided that (a) the audience does not exceed 500, and (b) the organiser gets consent for the performance on the relevant premises from: (i) the local authority concerned, or (ii) the school proprietor or (iii) the health care provider for the hospital.

Continued from previous page...

- Dance: no licence is required for performances between 08.00 and 23.00 on any day, provided that the audience does not exceed 500. However, a performance which amounts to adult entertainment remains licensable.
- Cross activity exemptions: no licence is required between 08.00 and 23.00 on any day, with no limit on audience size for:
 - o any entertainment taking place on the premises of the local authority where the entertainment is provided by or on behalf of the local authority;
 - o any entertainment taking place on the hospital premises of the health care provider where the entertainment is provided by or on behalf of the health care provider;
 - o any entertainment taking place on the premises of the school where the entertainment is provided by or on behalf of the school proprietor; and
 - o any entertainment (excluding films and a boxing or wrestling entertainment) taking place at a travelling circus, provided that (a) it takes place within a moveable structure that accommodates the audience, and (b) that the travelling circus has not been located on the same site for more than 28 consecutive days.

Section 18 of 18

PAYMENT DETAILS

This fee must be paid to the authority. If you complete the application online, you must pay it by debit or credit card.

Variation Fees are determined by the non-domestic rateable value of the premises.

To find out a premises non domestic rateable value go to the Valuation Office Agency site at http://www.voa.gov.uk/business_rates/index.htm

Band A - No RV to £4300 £100.00

Band B - £4301 to £33000 £190.00

Band C - £33001 to £8700 £315.00

Band D - £87001 to £12500 £450.00*

Band E - £125001 and over £635.00*

*If the premises rateable value is in Bands D or E and the premises is primarily used for the consumption of alcohol on the premises then you are required to pay a higher fee

Band D - £87001 to £12500 £900.00

Band E - £125001 and over £1,905.00

If you own a large premise you are subject to additional fees based upon the number in attendance at any one time

Capacity 5000-9999 £1,000.00

Capacity 10000 -14999 £2,000.00

Capacity 15000-19999 £4,000.00

Capacity 20000-29999 £8,000.00

Capacity 30000-39000 £16,000.00

Capacity 40000-49999 £24,000.00

Capacity 50000-59999 £32,000.00

Capacity 60000-69999 £40,000.00

Capacity 70000-79999 £48,000.00

Capacity 80000-89999 £56,000.00

Capacity 90000 and over £64,000.00

* Fee amount (£)

190.00

DECLARATION

I/We understand that it is an offence, under section 158 of the Licensing Act 2003, to make a false statement in or in connection with this application. Those who make a false statement may be liable on summary conviction to a fine of any amount.

Ticking this box indicates you have read and understood the above declaration

Continued from previous page...

This section should be completed by the applicant, unless you answered "Yes" to the question "Are you an agent acting on behalf of the applicant?"

* Full name

* Capacity

* Date / /
dd mm yyyy

Once you're finished you need to do the following:

1. Save this form to your computer by clicking file/save as...
2. Go back to <https://www.gov.uk/apply-for-a-licence/premises-licence/york/change-1> to upload this file and continue with your application.

Don't forget to make sure you have all your supporting documentation to hand.

IT IS AN OFFENCE, UNDER SECTION 158 OF THE LICENSING ACT 2003, TO MAKE A FALSE STATEMENT IN OR IN CONNECTION WITH THIS APPLICATION. THOSE WHO MAKE A FALSE STATEMENT MAY BE LIABLE ON SUMMARY CONVICTION TO A FINE OF ANY AMOUNT.

OFFICE USE ONLY

Applicant reference number	<input type="text"/>
Fee paid	<input type="text"/>
Payment provider reference	<input type="text"/>
ELMS Payment Reference	<input type="text"/>
Payment status	<input type="text"/>
Payment authorisation code	<input type="text"/>
Payment authorisation date	<input type="text"/>
Date and time submitted	<input type="text"/>
Approval deadline	<input type="text"/>
Error message	<input type="text"/>
Is Digitally signed	<input type="checkbox"/>

1 2 3 4 5 6 7 8 9 10 11 12 13 14 15 16 17 18 Next >

SHOPMATE

Unit 2 Haseley Rd Ind Estate
 Haseley Rd North
 Fillingworth, Manchester M35 9LU
 Tel 0161 681 9751 Fax 0161 681 9752 Mob 07976 724171

TITLE:
 Penny Petroleum
 605 Strensall Road
 Strensall
 York
 YO32 5TB

DRAWN BY:
 STW

DRAWING NO:
 T00424
 1:50 @ A3

CUSTOMER'S SIGNATURE:

DATE:
 Nov 18

REVISION:
 XXX

REPRESENTATIVE'S SIGNATURE:

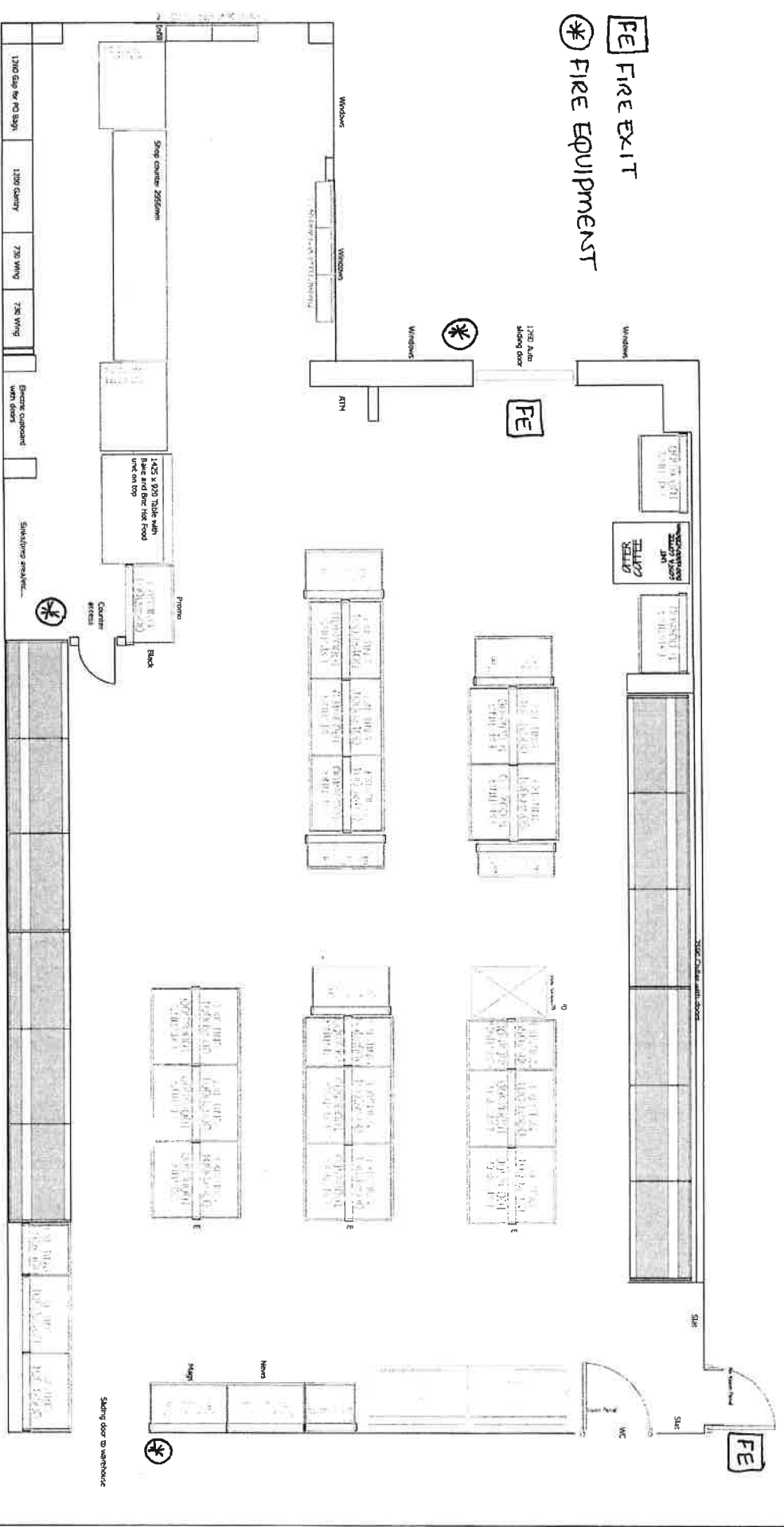

FE FIRE EXIT
 * FIRE EQUIPMENT

7990 Chiller on wheels

